







## Warrenfield Close, Cheshunt, Waltham Cross, EN7 5AR

Westwood Leber are delighted to bring to the market this deceptively spacious one bedroom first floor apartment positioned perfectly on this quiet residential road in Cheshunt. This property offers spacious living accommodation comprising of a large lounge/ diner and a sperate kitchen. Further benefits include ample storage, allocated parking, gas central heating and a redesigned shower room suite. An internal viewing is highly recommended!





**WESTWOODLEBER**

**WESTWOODLEBER**  
LET US GUIDE YOU HOME

## Apartment

Approx. 45.2 sq. metres (486.7 sq. feet)

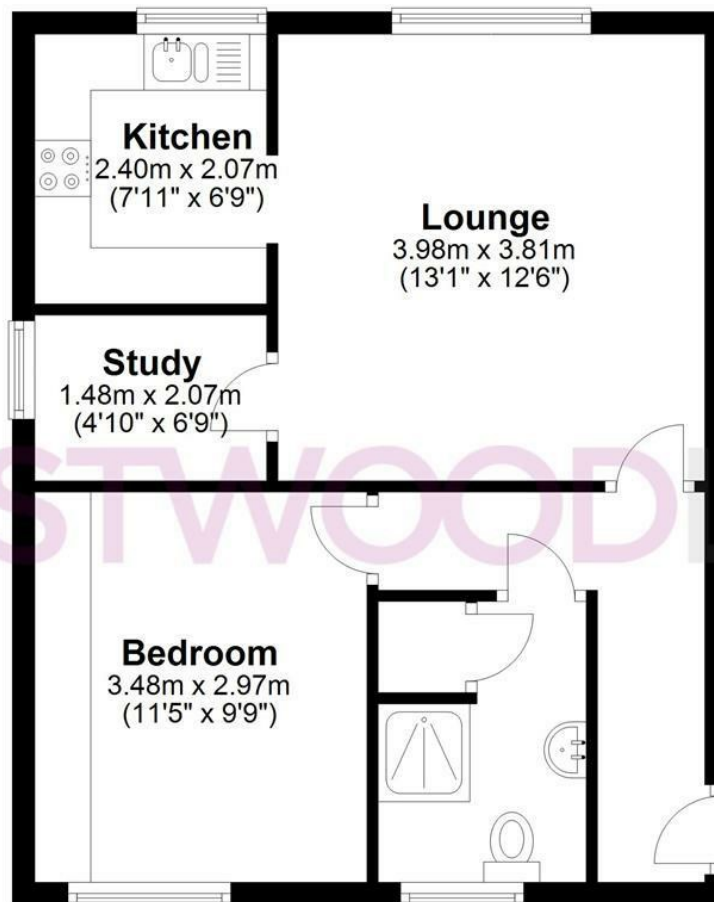

Total area: approx. 45.2 sq. metres (486.7 sq. feet)

THE FLOORPLAN IS FOR ILLUSTRATIVE PURPOSES ONLY AND IS NOT TO SCALE. Measurements and features are approximate and may differ from the actual property. Verify all details independently; no liability is accepted for errors or omissions.

Property marketing provided by [www.fotomarketing.co.uk](http://www.fotomarketing.co.uk)













